

LITHEAUDIO®

Bluetooth® GARDEN SPEAKER

INSTRUCTION MANUAL

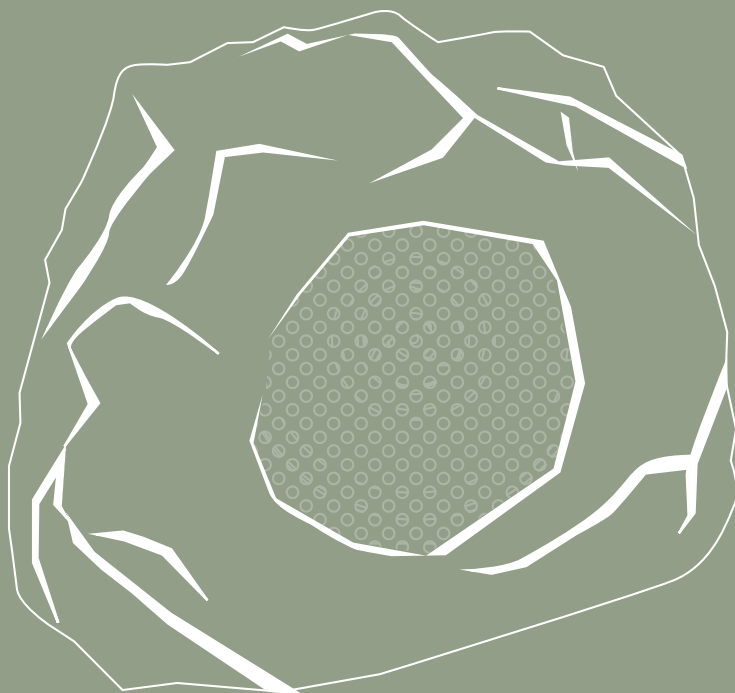

DONT FORGET TO REGISTER YOUR SPEAKER:

WWW.LITHEAUDIO.COM/REGISTER



SCAN ME

THANK YOU FOR CHOOSING LITHE AUDIO

Innovative design and advanced engineering come as standard in our LGS series of wireless Bluetooth Garden Rock Speakers. Designed for easy installation and high quality sound, within minutes your garden is setup and ready to rock!

IMPORTANT SAFETY WARNING

Before use please read completely and use in accordance with these safety instructions. Before commencing any electrical work ensure the supply is switched OFF at the mains. Either by switching off the consumer unit or by removing the appropriate fuse. This product should be installed in accordance with the relevant sections of the building regulations code and in accordance with the latest edition of IEE regulations (BS 7671).

If the unit is to be used as a replacement for an existing product, remove the existing unit from its location and disconnect the wiring. Connect the wires as shown in the diagram. Ensure terminals are properly tightened and ensure no bare wires are visible. When fitting the speaker into the ceiling, ensure no wires are trapped.

READ THE INSTRUCTIONS CAREFULLY BEFORE STARTING THE INSTALLATION PROCESS AND KEEP THEM SAFE FOR FUTURE REFERENCE.

- Failure to follow the instructions in this guide voids all warranties on your speakers.
- Warning: Do not use the product submerged in water.
- Protect the power cable from being damaged, do not over stretch cable.
- Only use attachments/accessories specified by the manufacturer Lithe Audio.
- Turn off the power to the speaker when unused for long periods of time.
- Do not open the back cover to the speaker as this protects the PCB, doing so will invalidate the warranty and could cause electric shock.
- This product complies with all European requirements for electrical safety and electromagnetic compatibility. This product complies with the Low Voltage Directive.
- The transformer must be connected to the mains (230Volt 50 Hz) and is suitable for outdoor and indoor use (IP68).
- If the external wiring (230 Volt 50 Hz) of the transformer has been damaged, the transformer must be destroyed.
- The product must not be changed or modified, as this may render it unsafe.
- Uses other than those for which the product was designed may result in damage and the risk of short-circuit, fire or electric shock.
- The plug of the transformer must not be plugged into the wall socket until the complete set has been installed.
- For questions about parts, service, any complaints or other matters, you can contact us at any time. E-mail us on info@litheaudio.com

KNOW YOUR SPEAKER

The Lithe Audio LGS range of Bluetooth Garden speakers features are detailed below:

SPEAKER OUTPUT - To connect one additional passive (Slave) speaker

POWER INPUT - To connect (as supplied) IP68 waterproof transformer

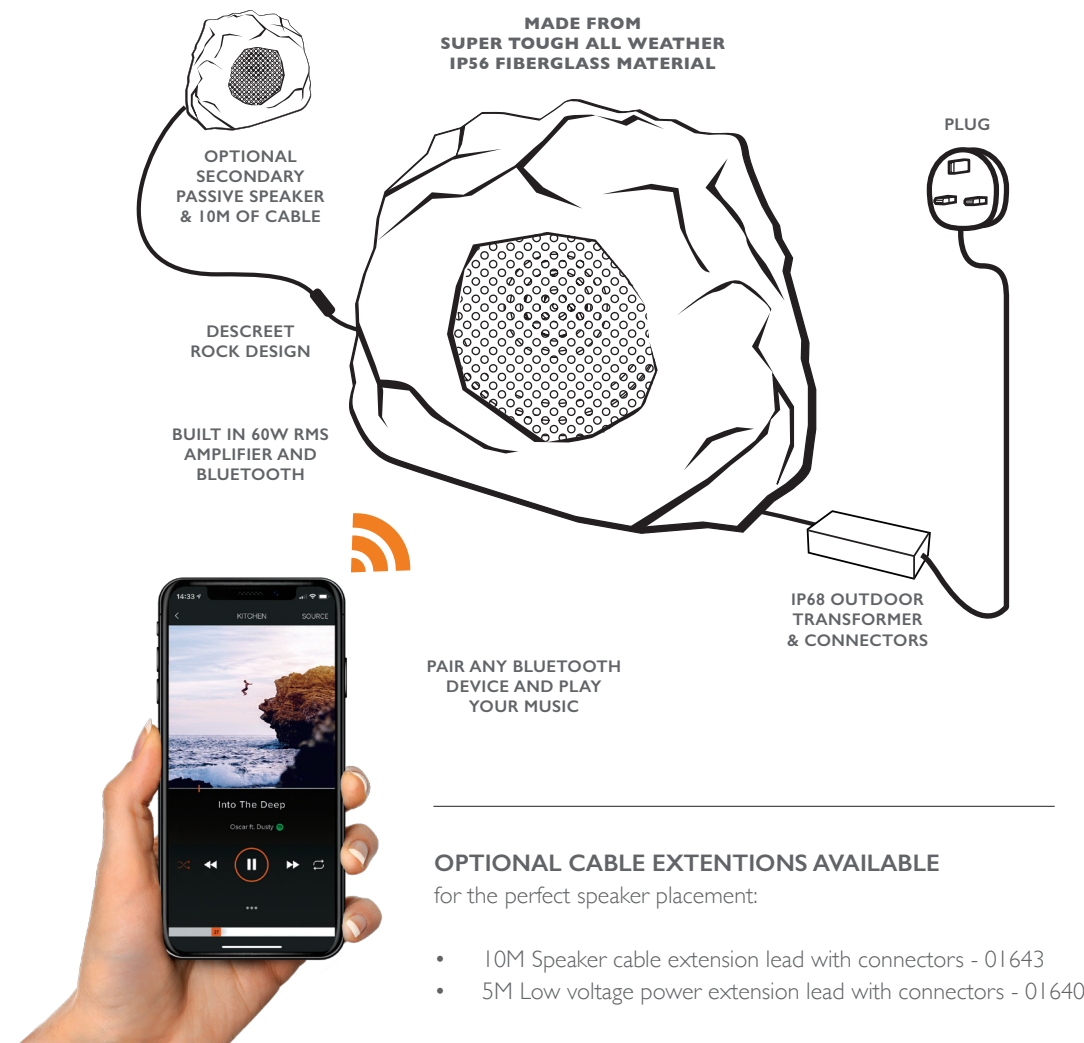

OPTIONAL CABLE EXTENTIONS AVAILABLE

for the perfect speaker placement:

- 10M Speaker cable extension lead with connectors - 01643
- 5M Low voltage power extension lead with connectors - 01640

BOX CONTENTS

Please ensure you read the entire instruction manual carefully before you commence any work. Carefully unpack the speaker from the packaging. Please check to ensure all the parts shown below are included.

If any parts of the speaker appear damaged, please contact your dealer/reseller immediately or contact info@litheaudio.com for contact details.

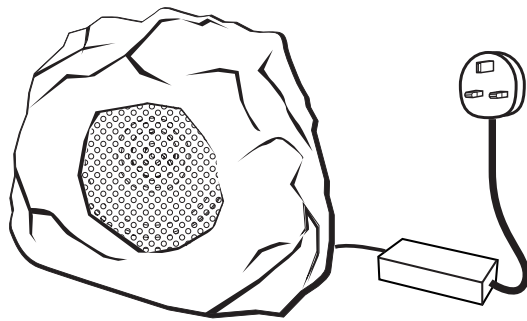

BLUETOOTH GARDEN
ROCK SPEAKER

POWER ADAPTOR
AND PLUG

PAIR MODELS ALSO INCLUDE

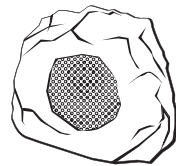

PASSIVE ROCK SPEAKER



10M SPEAKER CABLE

JUST ADD POWER

The speaker is designed to be plug and play. All you need to do is add power.

Simply plug into an outdoor plug socket, we recommend using an outdoor switched plug socket with RCD built in.

The speaker and transformer are designed to be installed and left outside, however you can also plug in to an indoor plug socket if you plan to only take out whilst entertaining.

Note: When leaving the transformer outdoors, whether or not it's housed, make sure it's lifted and fitted well off ground (above the damp course level) to avoid being flooded or buried in snow; and use common sense when near to water bearing fittings such as down pipes, leaking gutters, ponds etc. When not in use, turn off the plug socket power switch.

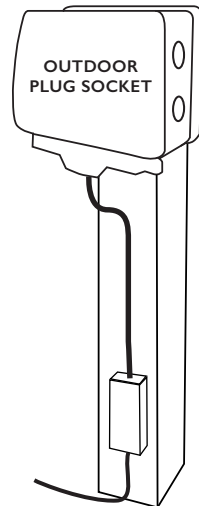

INSTALLATION

IMPORTANT: Always place this product so that it can still be accessed for servicing or maintenance. This product must never be permanently embedded or bricked in. When not in use, turn off the speaker from the plug socket.

1. Plan out the best position of the speaker for your garden layout. Lay the cables on the ground and place the speaker where it will be positioned. Ensure there is enough slack for burying the cable.
2. Using a small spade dig a shallow trench away from any areas you may dig up in the future approx 10cm deep, lay the low voltage cable checking it is not damaged as you go in the trench and the cover with soil or garden media.

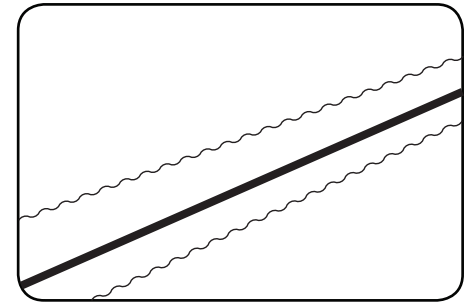
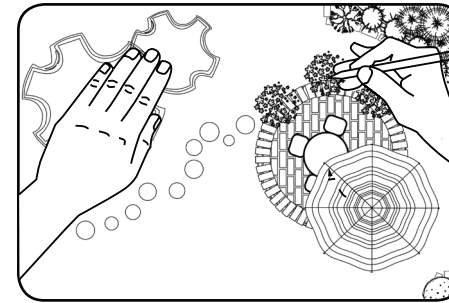

3. Position the transformer above the damp course level and use the 4x screw holes to fix the transformer in place.

4. Check all the cables and connectors are secured in place and then plug in the speaker to an outdoor plug socket, then turn on the power.

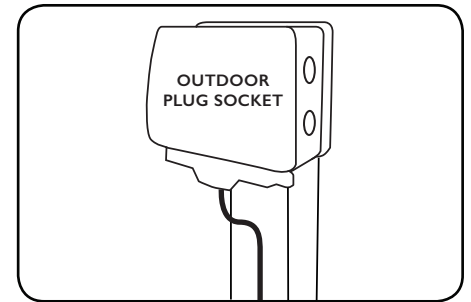
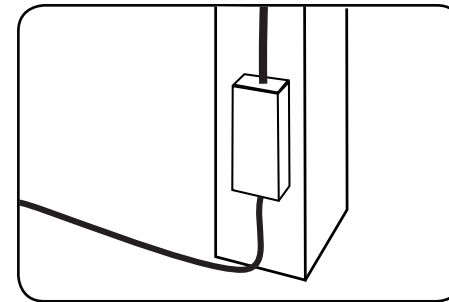

EXTENSION CABLES

5M Low voltage power cable extension leads and 10M Speaker cable extension leads are available. See product codes to the left. These can be linked together to achieve longer lengths. Ensure the power is turned off when adding extensions & check connectors are tight before turning the power back on.

ADDITIONAL SPEAKER - OPTIONAL

PLEASE NOTE: SINGLE MASTER MODEL DOES NOT INCLUDE PASSIVE SPEAKER

The Bluetooth Garden Speaker is able to connect to and power an additional passive speaker via the speaker output (+/-). Use wire cutters to strip the ends of the speaker cable (if required). Insert in to the cable connector attached to the master speaker:

FITTING INSTRUCTION VIDEO

OPEN YOUR PHONE CAMERA & SCAN THIS QR CODE TO VIEW A VIDEO TO SEE HOW TO CONNECT THE CONNECTOR

Loosen the end caps, insert the cable in to the connector block and tighten the end caps back to the center. Check the connector is tight and sealed.

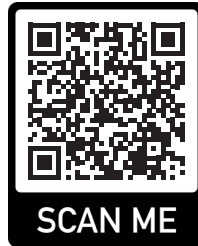

SETUP AND PAIRING

NOTE: ENSURE THE BLUETOOTH GARDEN SPEAKER IS CONNECTED TO THE POWER SUPPLY AND TURNED ON.

You will hear 3 beeps once the speaker has powered up and is ready to pair to your phone tablet of voice control device.

1. Open the setting menu and select Bluetooth.
2. Turn on Bluetooth and search devices.
3. The Lithe Audio Bluetooth speaker is now connected to your device ready to play your Music.



NOTE: If your connection to speaker is lost, the device maybe out of range (> 10m). To reconnect simply go to the Bluetooth setting menu on your device and reconnect to Lithe Audio speaker.

SPECIFICATIONS

- Sound Quality THD+N < 0.009%, 65Hz-20kHz
- RMS Power: 60W RMS (2x30W)
- Impedance: 8 Ohms
- Sensitivity (1W/1m): 90dB
- Audio Sample Rate: 8KHz
- Type: Class D (Digital)
- Woofer: 6.5" Polypropylene Cone
- Tweeter: 0.75" Mylar Cone
- Bluetooth System: Bluetooth V4.0
- Frequency Range: 2.4GHz - 2.4832GHz (ISM Band)
- RF Channels: 79 (USA, Japan & EU)
- Wireless Range: Up to 10 metres
- ID Device Name: Lithe Audio GS
- Power Input Supply : 100 - 240V ~
- Transformer Output Supply : DC24V / 2.5A
- Rock size: 340x250x260 mm
- Rock Weight: 6.8Kg
- Operating temperature: -20°C to 85°C
- Standby power: 1.3W / 0.02A
- Connected power: 1.5W / 0.03A
- Playing Music: 2.8W - 10.5W / 0.03A - 0.09A**

* Specifications subject to change without notice.
** Power Consumption depends on the type of music & volume - Increased Bass & volume requires more power loading on the amplifier.

REGULATION INFORMATION

Europe

LitheAudio declares that this product herewith complies with the requirements of the EMC Directive 2004/108/EC, Low Voltage directive 2006/95/EC, Eco-Design Directive 2005/32/EC, RoHS Directive 2011/65/EU and the R&TTE Directive 1999/5/EC when installed and used in accordance with the manufacturer's instructions. A copy of the full Declaration of Conformance may be obtained at www.litheaudio.com/support/policies.

Lithe Audio Speakers have a standby mode or remove the power cord from the AC mains.

Recycling Information

This symbol on the product or on its packaging indicates that this product shall not be treated as household waste.

Instead please deliver it to the applicable collection point for the recycling of electrical and electronic equipment. By recycling this product correctly, you will help conserve natural resources and prevent potential negative environmental consequences. For more detailed information about recycling of this product, please contact your local council office, your household waste disposal service or the shop where you purchased the product(s) from.

If a problem arises, visit support.litheaudio.com or contact Lithe Audio Customer Service Support on support@litheaudio.com or Call +44 (0) 1293 922 015

2 YEAR GUARANTEE

This Garden Speaker is of excellent quality and construction. However, if any defects in materials or workmanship do appear during the guarantee period, we will, at our discretion, either repair or replace the defective parts, free of charge, subject to the terms and conditions of our Guarantee shown below.

This Guarantee covers both parts and labour. Carriage is not included.

This Guarantee provides benefits which are additional to, and do not affect, your statutory rights. This Guarantee does not cover the cost of returning the product to the dealer from whom it was purchased or to ourselves. This Guarantee applies only to products sold and located in mainland Great Britain. It does not cover liability in respect of or replacement of plugs, cables or fuses and also does not cover defects due to:

- Failure to use or maintain product in accordance with Lithe Audio instructions.
- The product being connected to an unsuitable electricity supply.
- Accidental damage to or abuse or misuse of the product.
- Product modification, except by Lithe Audio or approved agent.
- Dismantling of or interference with the product.

Before returning any product under this Guarantee, please check that:

- You have followed the product instructions correctly.
- Your mains electricity supply is functional.
- The defect is not due to a blown fuse.

If you wish to claim under this guarantee you should:

- Send the product, postage or carriage paid, to the dealer from whom it was purchased or to Lithe Audio direct.
- Ensure that the product is clean and packed carefully (preferably in its original carton).
- Enclose details of your name, address and telephone number and when and where the product was purchased, together with proof of purchase (e.g. a invoice or till receipt).
- Give exact details of the nature of the defect.

This Guarantee does not cover any other claims whatsoever, including, without limitation, any liability for incidental, indirect or consequential damage, nor does it cover any claims for conversion or modification or for the costs of repair carried out by any third party without the prior consent of Lithe Audio. If replacement parts are fitted to the product this will not extend the period of the Guarantee. For further advice contact the Lithe Audio customer services.



Lithe Audio products marked with the CE mark comply with the EC Low Voltage Directive: 73/23/EEC, Electromagnetic Compatibility Directive 89/336/EEC